



CHI***** GENEVE 2023



Class No. 15

ROLEX GRAND PRIX

Competition with one jump-off

Sonntag, 10. Dezember 2023

Start: 14:30

Table: A
National RG:
FEI RG / Art. 238.2.2
Height: 1,60 m

Speed: 375 m/min
Length: 455 m
Time allowed: 73 sec
Time limit: 146 sec

Obstacles: 14
Efforts: 18

1st Jump-off: **16-9-2-17-4-5AB-6-7B**
Length: 320 m
Time allowed: 52 sec
Time limit: 104 sec

Course Designer: Gérard Lachat (SUI)
Louis Konickx (NED)

Assistants: Reto Ruffin (SUI)
Julien Pradervand (SUI)
Marco Cortinovis (ITA)

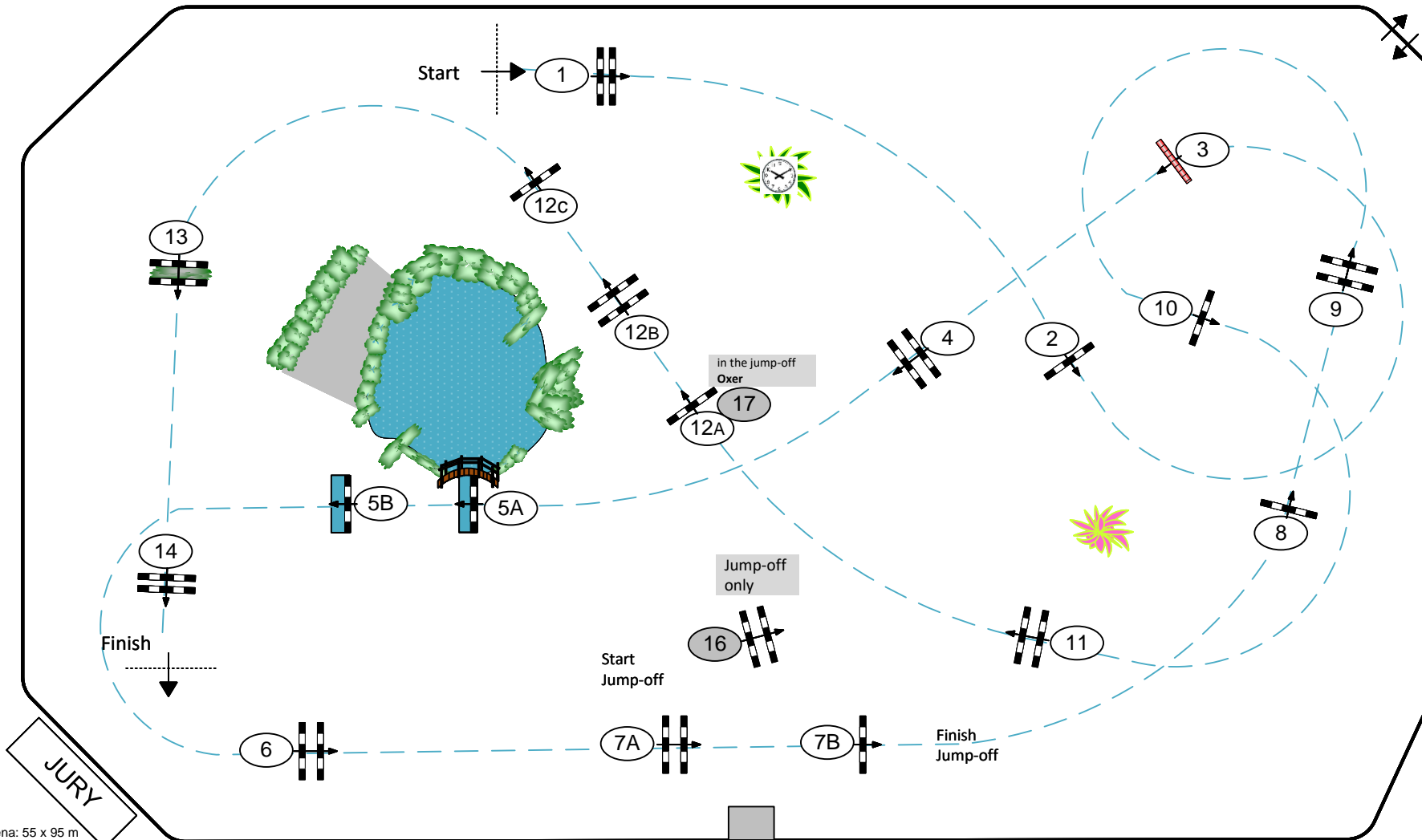

Arena: 55 x 95 m